

TEKLA BASECAMP

AUG. 27 - 29

2
0
1
9

What's new for Drawings



DOCUMENT MANAGER



Document Manager

- Document Manager replaces drawing list

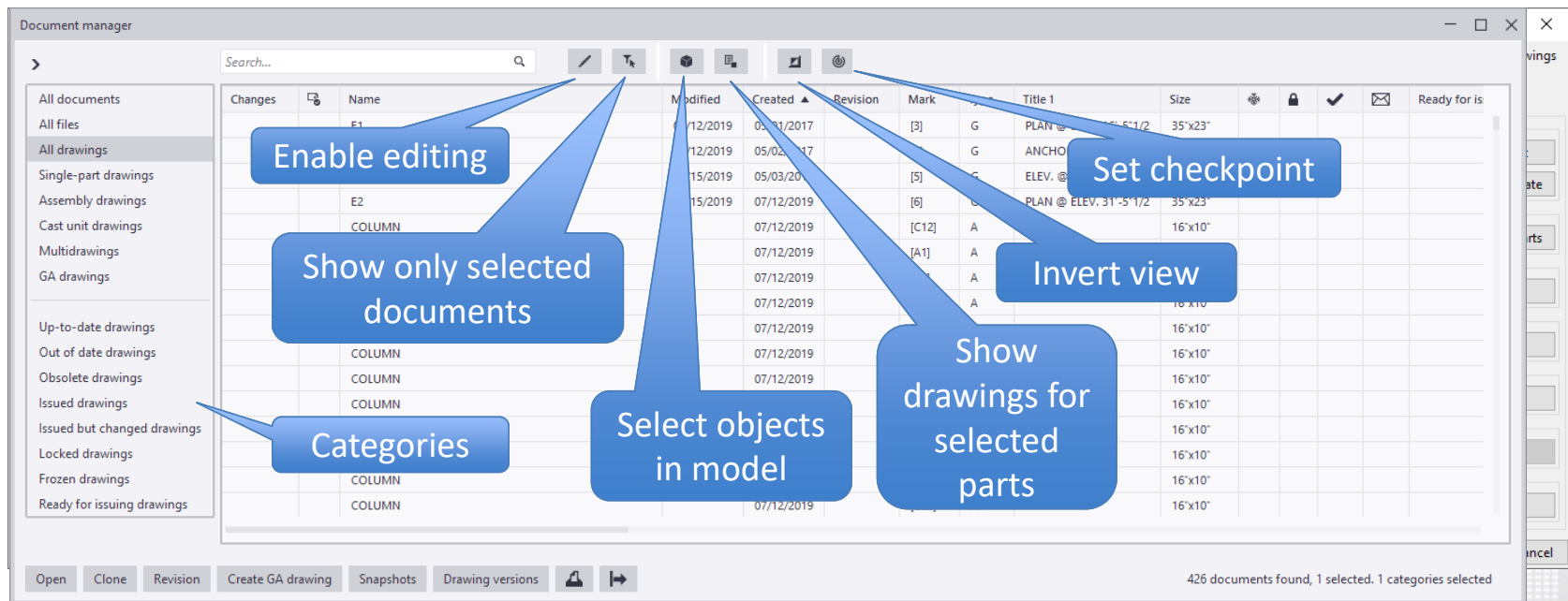

Document Manager

- List and manage All file types, not just drawings



Document Manager

- List and manage All file types, not just drawings



Document Manager

- List and manage All file types, not just drawings
- Hide/move columns
- Easier to add drawing UDAs
- Freeze columns when scrolling right
- Powerful search
- Shows GA drawings that the members are on
 - Or select drawing and highlight objects on that drawing
- Edit fields like Name and Title from the list
- Categorize, view files and drawings
- View combinations of categories

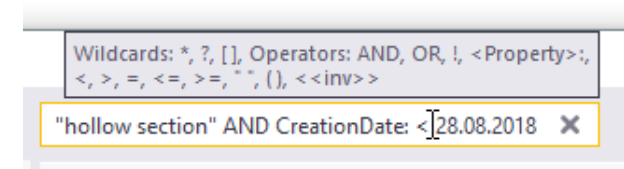

Created	Modified
28.08.2018	28.08.2018

Document Manager – Search-based Categories

- Create a Rule to automatically put drawings in a certain category
 - Based on same search rules
 - Group based on UDA (drawn/checked/approved)
 - Drawings by date, name, type
 - Files by type



Document Manager – Manual Categories

- Create custom categories on the fly
- Organize your documents in manual categories to:
 - Create a folder with set of documents issued on a date (NC, Tekla Drawings, PDFs, DWGs)
 - For documents that would be difficult to categorize using the search
 - In Shared model environment others can see who is working on what drawings
 - Drawing office manager can assign drawing to different detailers in the office to be reviewed or cleaned up



Document Manager

- New right-click menu options
 - Categories
 - Copy and paste visible list
 - Copy to new sheet

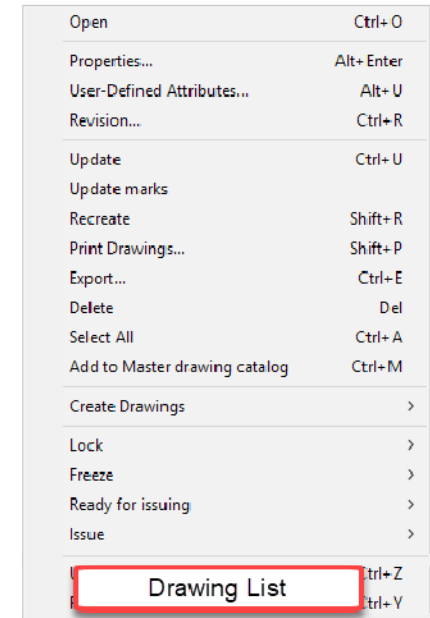
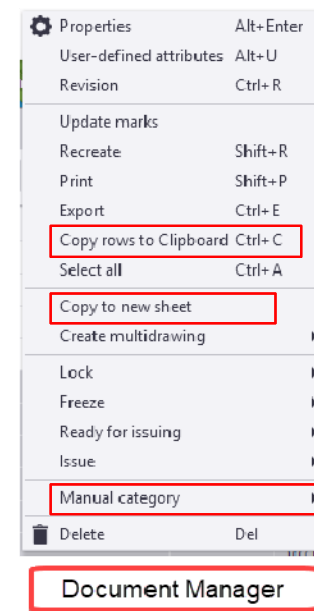

Old and busted

- ~~Cannot reorganize columns~~
- ~~Cannot Hide or remove unwanted columns~~
- ~~Limited drawing UDA support~~
- ~~No way to group drawings~~
- ~~Only shows drawings, no other files~~
- ~~Must open drawing to rename or edit~~
- ~~Scroll over – what was I looking at again?~~

Document Manager - Nerdy details

- DocumentManagerFileDocumentSettings.txt
 - File paths and extensions that can be included
- DocumentManagerUDAs.txt
 - Which drawing UDAs should be shown
- DocumentManagerDataGridSettings.xml
- DocumentManagerCategories.xml

```
// This file defines the directories to scan for files that should be displayed in Document Manager.
// Note: The file should be Unicode and not ASCII format.
// The format of each line is <DirectoryPathAndFileNamePattern>[<IncludeSubdirectories>]
// <DirectoryPathAndFileNamePattern> = A relative or absolute path and file name pattern.
// A relative model subdirectory would be specified using a leading full stop.
// The file name pattern supports the standard ? and * wildcards.
// <IncludeSubdirectories> = true to include subdirectories and false to not include subdirectories.
// For example: .\Plotfiles\*.pdf|false
.\Plotfiles\*.pdf|false
.\Plotfiles\*.dxf|false
.\Plotfiles\*.dwg|false
.\Reports\*.pdf|false
.\Reports\*.xsr|false
.\Reports\*.html|false
.\Reports\*.xls|false
.\Reports\*.Excel|false
.\DSTV_Plates\*.ncl|false
.\DSTV_Profiles\*.ncl|false
.\VK_dxf\*.dxf|false
```

```
// This file lists the user-defined attribute names that should be made available for searching and display in Document Manager.
// The name is the internal name of the user-defined attribute definition as specified in the matching objects.inp file.
// User-defined attribute names are case sensitive.
DR_APPROVAL_DATE
DR_APPROVAL_SENT
DR_APPROVED_BY
DR_ASSIGNED_BY
DR_ASSIGNED_TO
DR_CHECKED_BY
DR_CHECKED_DATE
DR_DRAWN_BY
comment
```

Drawing Version History

- View and open previous versions
 - View snapshots, overlay to see changes
 - View deleted drawing snapshots too
- Restore previous versions
 - Open and save to restore 'lost' versions when there are user conflicts or errors
 - *Cannot restore deleted drawings
- Compare to other drawings or models
 - Check backup version content
 - View snapshots from the other model

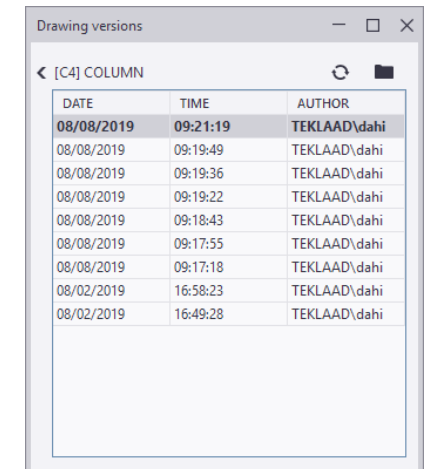
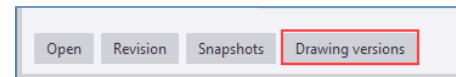

A screenshot of a 'Drawing versions' dialog box for '[C4] COLUMN'. It displays a table with columns for DATE, TIME, and AUTHOR. The data is as follows:

DATE	TIME	AUTHOR
08/08/2019	09:21:19	TEKLAAD\dahi
08/08/2019	09:19:49	TEKLAAD\dahi
08/08/2019	09:19:36	TEKLAAD\dahi
08/08/2019	09:19:22	TEKLAAD\dahi
08/08/2019	09:18:43	TEKLAAD\dahi
08/08/2019	09:17:55	TEKLAAD\dahi
08/08/2019	09:17:18	TEKLAAD\dahi
08/02/2019	16:58:23	TEKLAAD\dahi
08/02/2019	16:49:28	TEKLAAD\dahi

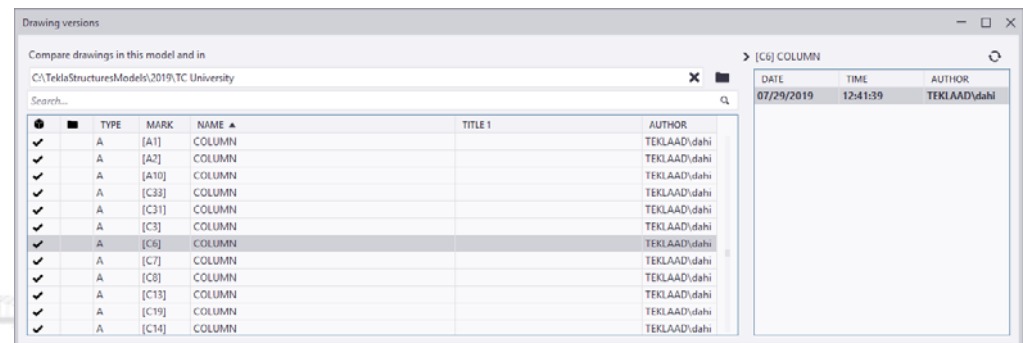

A screenshot of a 'Drawing versions' dialog box for '[C6] COLUMN'. It shows a comparison of drawings in this model and in another model. The main table lists various columns with their types, marks, names, and authors. The data is as follows:

TYPE	MARK	NAME	TITLE 1	AUTHOR
✓ A	[A1]	COLUMN		TEKLAAD\dahi
✓ A	[A2]	COLUMN		TEKLAAD\dahi
✓ A	[A10]	COLUMN		TEKLAAD\dahi
✓ A	[C33]	COLUMN		TEKLAAD\dahi
✓ A	[C31]	COLUMN		TEKLAAD\dahi
✓ A	[C3]	COLUMN		TEKLAAD\dahi
✓ A	[C6]	COLUMN		TEKLAAD\dahi
✓ A	[C7]	COLUMN		TEKLAAD\dahi
✓ A	[C8]	COLUMN		TEKLAAD\dahi
✓ A	[C13]	COLUMN		TEKLAAD\dahi
✓ A	[C19]	COLUMN		TEKLAAD\dahi
✓ A	[C14]	COLUMN		TEKLAAD\dahi

On the right side of the dialog, there is a smaller table for '[C6] COLUMN' with columns for DATE, TIME, and AUTHOR. The data is as follows:

DATE	TIME	AUTHOR
07/29/2019	12:41:39	TEKLAAD\dahi

DRAWING CONTENT MANAGER



Drawing Content Manager

- Quick and easy way to review, add and locate drawing content.
 - Review relevant content for checking and editing purposes, and target actions on single or multiple model objects or marks simultaneously
 - Modify, remove or add model object marks, without drawing properties set-up, including associative notes
 - Check how many marks model objects have in one view or in the entire drawing

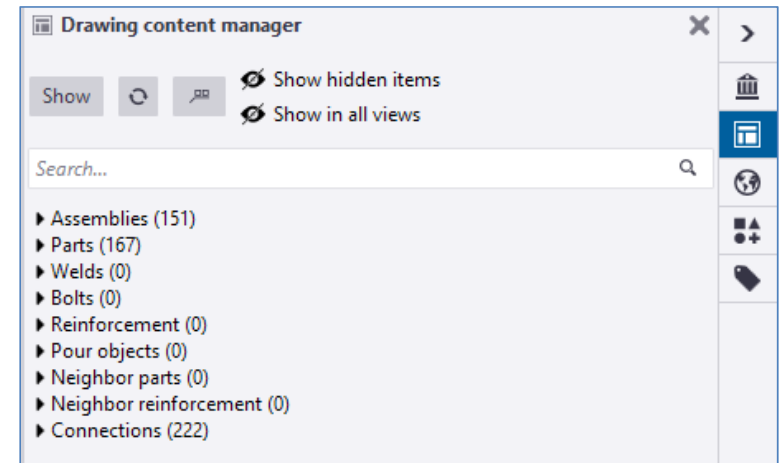

Drawing Content Manager

- Control the visible object categories
- Customize columns and visible properties

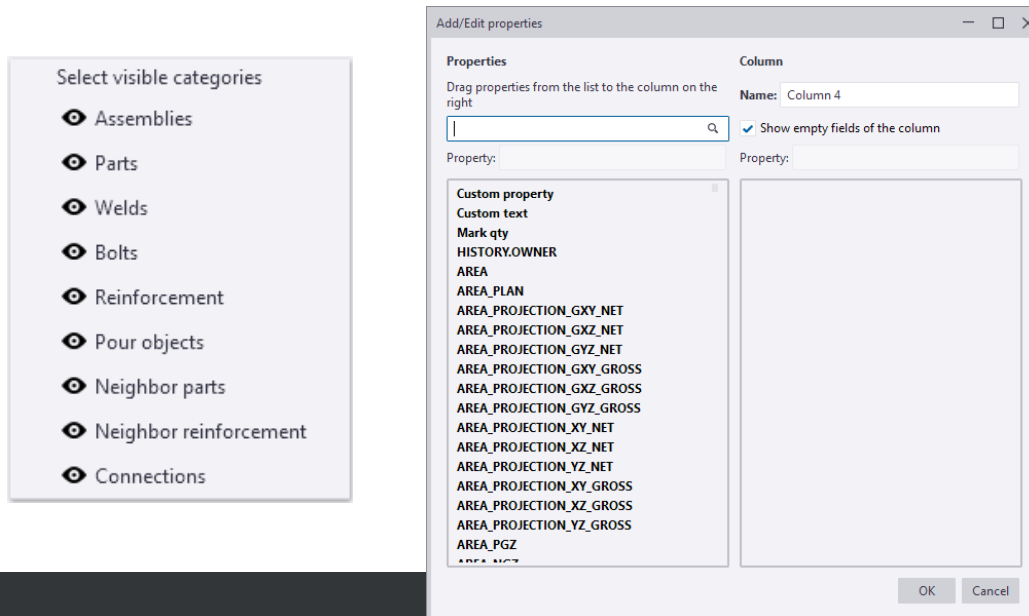

DRAWING EDITING



Productive Drawing Editing

Drag & drop on drawings

- Move annotations with one click
 - Drag and drop marks, associative notes, text, etc. with 1 click
- Move and modify dimensions with ease
 - Drag to change dimension points
 - Update the zero point
 - Drag to existing location to delete

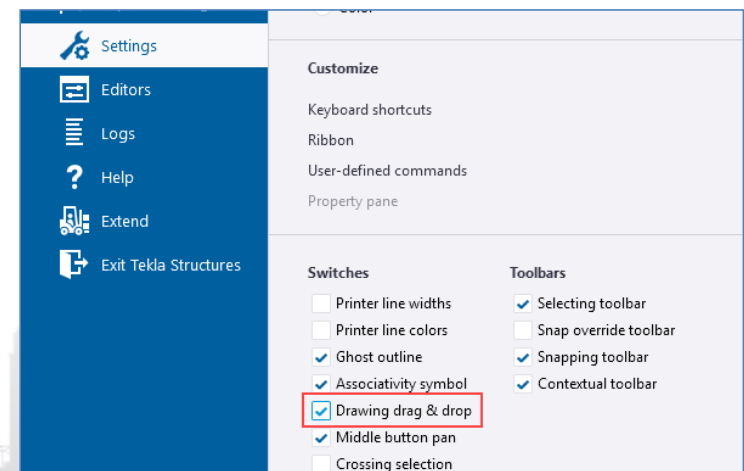

Dimension Point Associativity Control

Specify exactly which object a dimension points to...

- Improves drawing updating
- Improves cloning
- Key to Clone selected

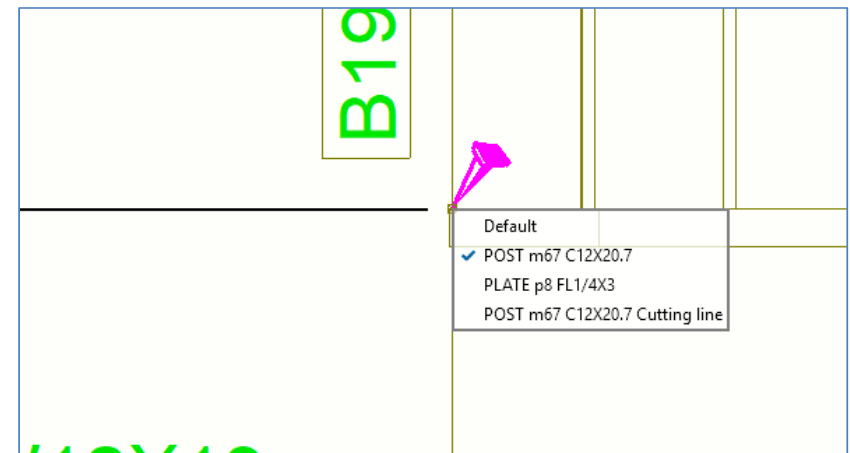

Control dimension associativity for error free updating and improved cloning

Snapping and selection

- Snap to circle center in drawings
- XS_ADD_SNAPPING_SYMBOL_TO_CIRCLES to TRUE
- Circular part cuts will have center snap (must be full circle)
- GA drawings are not supporting this, as it may cause a performance hit.

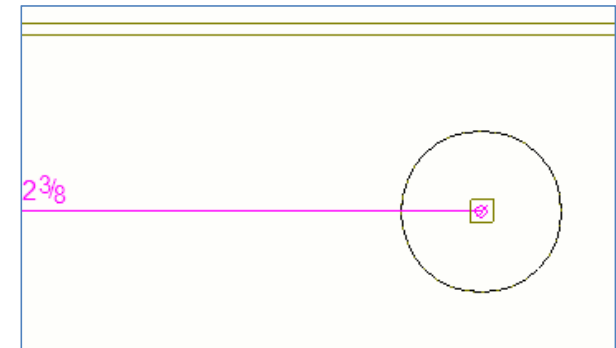

Advanced Options - Search results

Search

Type	Name	Value
DRAWINGS	XS_ADD_SNAPPING_SYMBOL_TO_CIRCLES	TRUE

Snapping and selection

- In filter properties on drawing and view dialogs multiple objects selection is allowed for objects on a drawing.
- Window select in the selection filter is possible

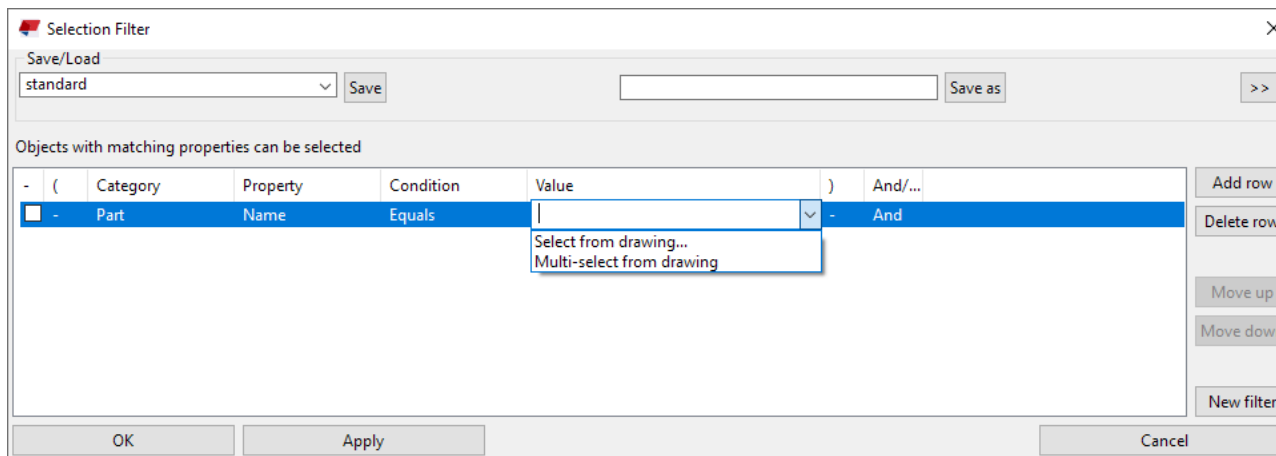

- Also available in the model

Manual mark placement improvements

New mark alignment commands

- Select marks and run Auto-arrange marks to avoid crossing leader lines.



- Select marks and run Auto-align marks in close proximity to stack them and place them evenly.
- Select Align to a point to manually place the grouped marks

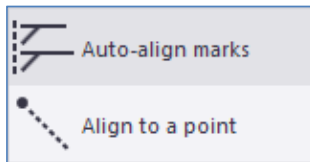

Manual mark placement improvements

- The Arrange drawing objects command from right-click menu - Near current location and Ignore current locations work for fixed marks and not only for free marks.

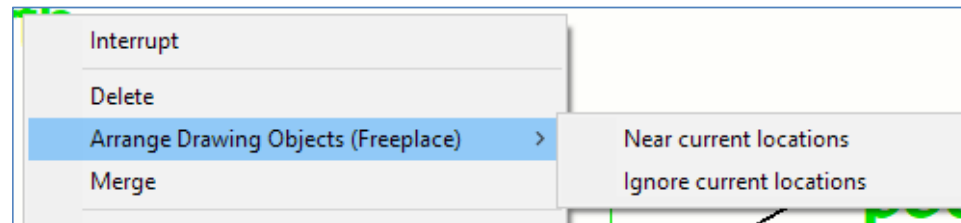

- Select marks switch works also for associative notes

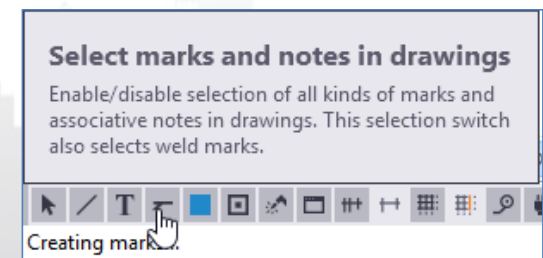

Mark text Alignment

- Align text in marks and associative notes
- Manually set mark rotation
 - Columns now set to not use 45 degree advanced option, instead use object level settings with rotation in mark

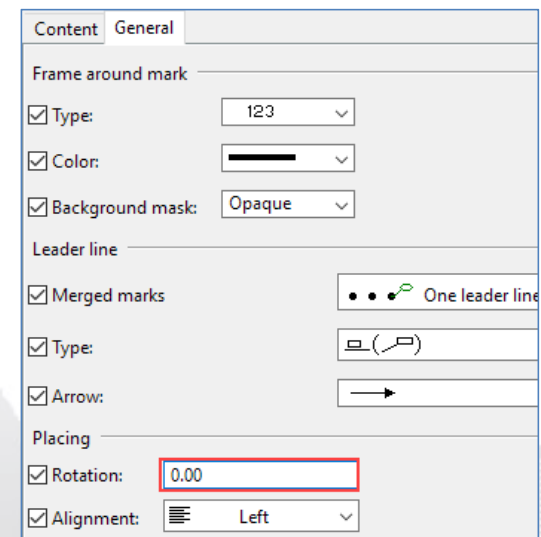
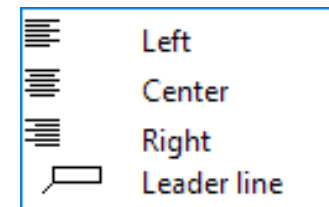

Symbol with partial profile

- Length and offset from middle point can be adjusted

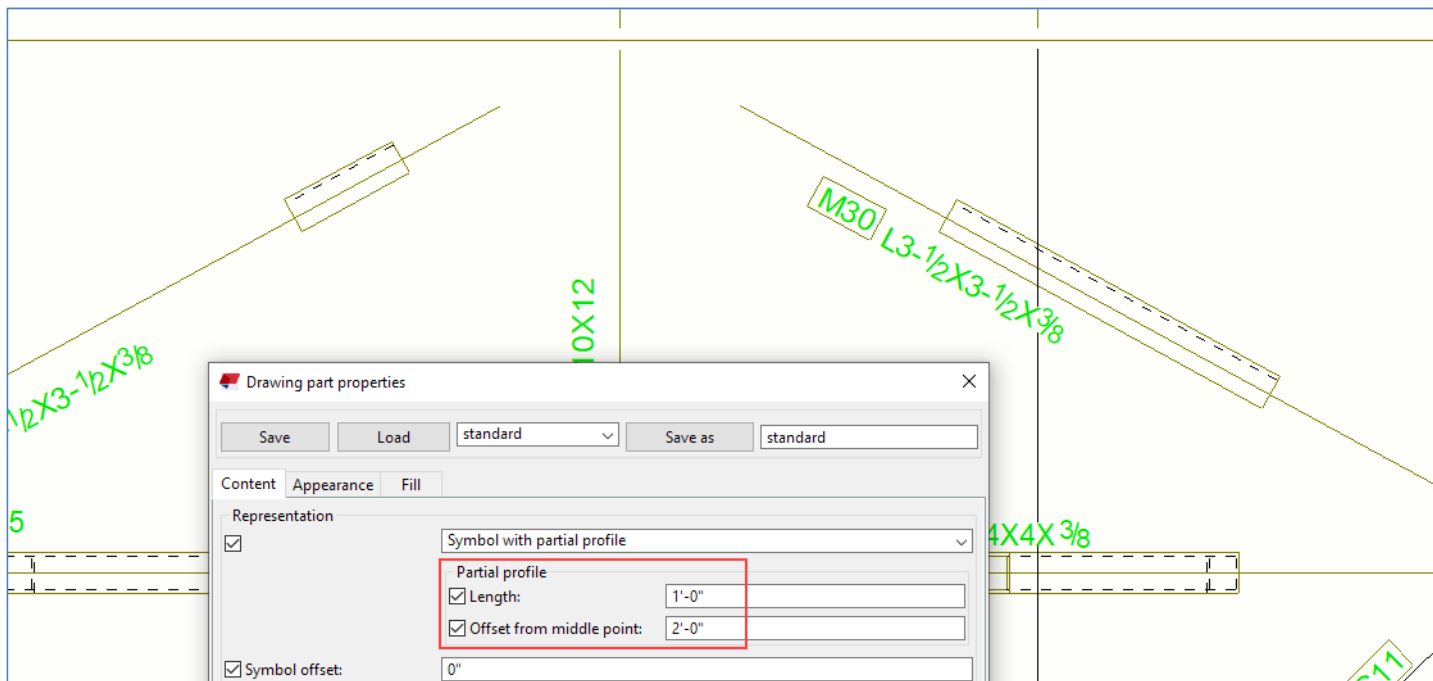

CLONING



Clone Selected

- “Smart copy” drawing editing to similar areas and objects in the same general arrangement drawing
 - Clone dimensions, marks, part presentation, line work, etc.

Save time editing and preparing GA drawings with repeated content

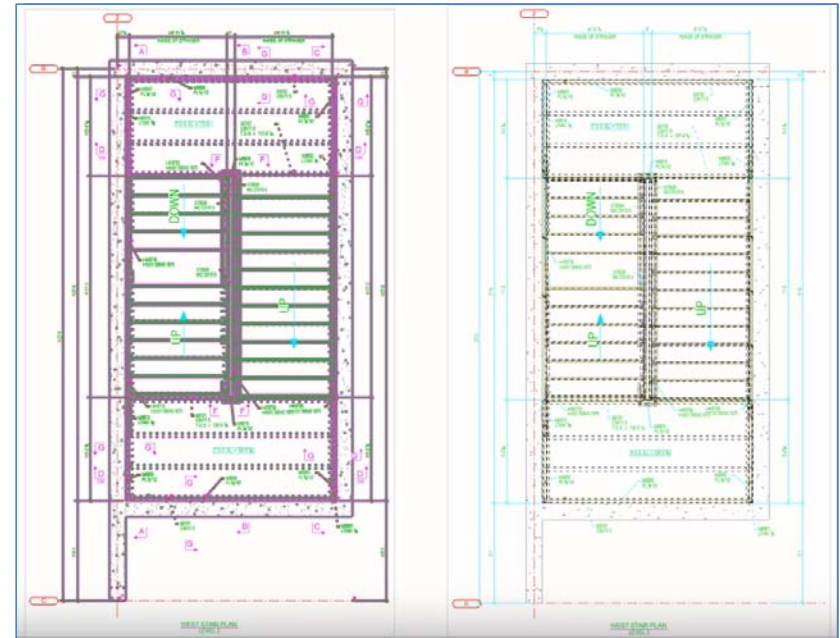

Clone selected

- Temporarily copy views from other GA drawings to clone across drawings
- Once finished a part of a drawing or a full one, you can clone the presentation of parts and their annotations to a similar targeted area
 - Merge: Recreates annotations & parts representations for the matching content
 - Keep all: Adds only new annotations from the source
 - Discard all: Recreates annotations & parts representations all over

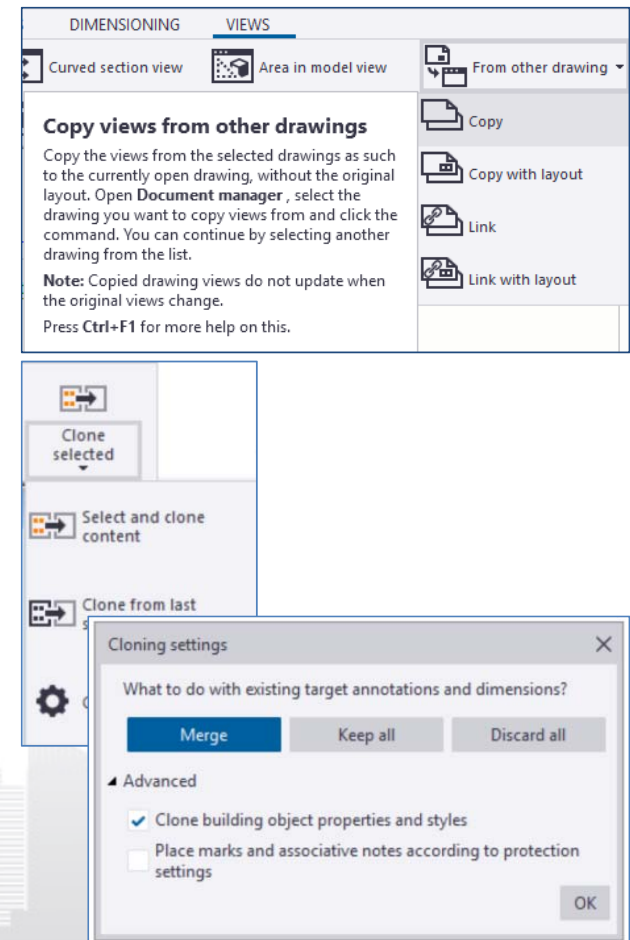

DRAWING LAYOUTS



Drawing Layouts

Placing and moving templates in drawing layouts is now more straight forward.

- Place templates with drag & drop
- Templates are positioned automatically
 - pick a corner or a midpoint on the drawing frame or on an existing template.
- The templates now try to avoid overlapping with the existing templates
- The anchor snaps automatically to the closest corner or middle point of the drawing frame or the existing template
- Use previously available Move command, if need to move tables precisely

Templates on drawings

- It is now possible to refresh a template. When editing a template in an open drawing you don't need to reopen a drawing anymore. Refresh a template instead.

BILL OF MATERIAL						REV	D
MARK	QTY	DESCRIPTION	LENGTH	WEIGHT	REMARKS	FAB-A	FAB-C
A1	1	COLUMN			SQ-2		
A1	1	HSS4X4X1/4			A1085	DESCRIPTION	
p22	2	FL3/8X3 1/2			A38	PROJECT N	
p28	2	FL3/4X5			A38	DRAWN BY	
TOTAL WEIGHT THIS D							DATE DRAV

Interrupt

Open Layout editor

Edit template in Template Editor

Refresh template

TEMPLATE EDITOR



Template Editor

- New Template Editor was issued with Tekla Structures 2018
- Several dialog boxes can be opened at the same time
- New templates open in new application windows
- Search for Attribute names or descriptions
 - Type any part of the word. Search happens on the fly.
 - Attribute descriptions included in search with translations
 - Need to expand collapsed attribute groups to see if there are search results under them.

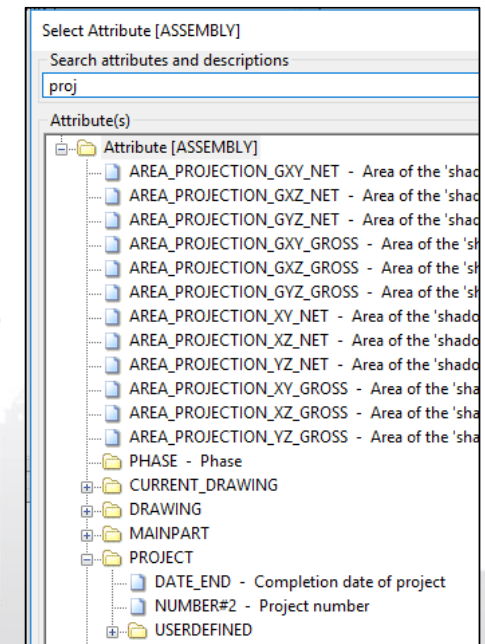

Template Editor - usability improvements

- Selection filter for all objects (text, lines, functions, symbols, etc.)

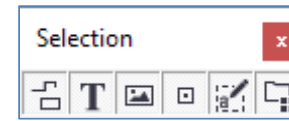

- Trim/Extend tools for linework



- Expand and collapse Preview Pane and tree dynamically without undocking.

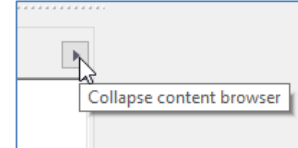

- Output fields that are cut off show ***

p93	1	PL3/8X13 5/8	1'-2 3/8
p94	1	PL3/8X13 1/4	1'-2 3/4
p110	2	FL11/16X4 3/4	1'-3
A3	2	VERTICA***	
A3	2	HSS6X6X3/8	20'-4 1***

THANK YOU!

